

PART NUMBER	DESCRIPTION	MATERIAL	APPLICATION	QTY.
<b>175-50-35</b>	276ltr Series A Moulded Tank	9mm MDPE		1

TEK-TANKS USE ONLY

Can be used for placement of hatch or fitting if applicable to requirement

Otherwise, hole will be plugged

Tooling Hole

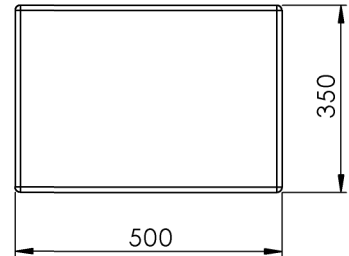
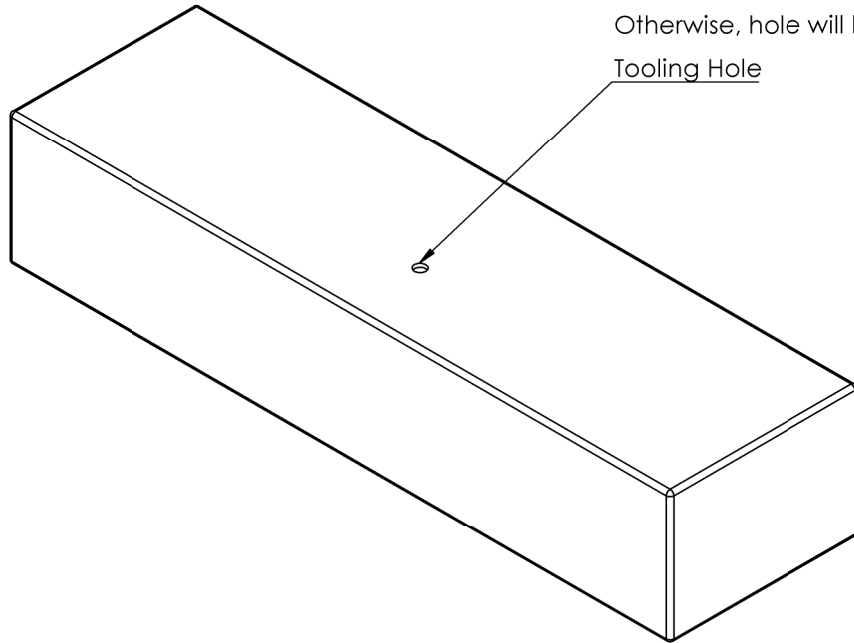
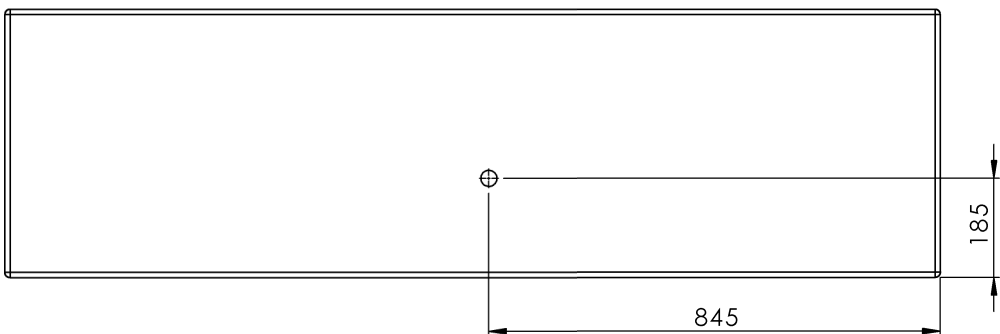

APPLICATION	✓	FITTING SPECIFICATION			
		TYPE	SIZE	DESCRIPTION	QTY
DIESEL					
OIL		#	EXAMPLE	38mm 90° Elbow Hosetail	1
FRESH WATER		A	FILLER/INLET		
GREY WATER		B	VENT		
WASTE		C	FEED/OUTLET		
		D	RETURN/INLET		
		E	DRAIN		
		F	SENDER		
		G	HATCH		

**TEK TANKS**  
 Tek-Tanks LTD, The Old Stables, West End Farm,  
 Upper Froyle, Alton, Hampshire, GU34 4JR  
 tel: 01420 520 830 fax: 01420 520 840  
 email: enquiries@tek-tanks.com web: www.tek-tanks.com

TITLE:  
**276ltr Series A Moulded Tank**

DWG NO.  
**175-50-35**

REVISION

DATE: 12 September 2014 DRAWN BY: richardab

Dimensions in 'mm' - Do Not Scale